

## **SPECIFICATIONS**

### **GENERAL**

Aluminum framing shall be Marlin System (45 or 45T thermally improved - Architect to specify) as manufactured by Marlin windows.

### **MATERIALS**

All framing shall be aluminum extrusions of 6063-T5 alloy & temper. System 45T shall have a rigid polyurethane "thermal-barrier" as an integral contact between the interior and exterior aluminum sections including the door framing members utilizing a "thermal-break" door stop. Glazing gaskets shall be extruded E.P.D.M.

### **FINISH**

Standard architectural Class II anodic color conforming to Aluminum Association AA-M12-C22-A34 for dark bronze or AA-M12-C22-A31 for clear anodize. (Architectural Class I and Class II anodic finishes and organic coatings available - specify).

### **CONSTRUCTION**

Aluminum framing shall have a 2" face width and a depth of 6" and provide for flush glazing without projecting stops. The system shall use a continuous sub sill. Optional thermally improved concealed project-out vent (Architect specify). Additional sight line shall not exceed 1 3/8". (Consult factory for hardware and screen options.) **Maximum vent size 60" x 36"**.

### **PERFORMANCE**

System shall be tested in accordance with AAMA 501 and meet the requirements of ASTM E 283 for air infiltration, and ASTM E 331 for water penetration, and ASTM E 330 for structural performance. Deflection of mullions shall be limited to L/175 when subjected to the project design pressure of \_\_\_\_ P.S.F. (Architect to specify).

### **GLAZING**

Marlin system 45/45T shall accommodate 1" glazing as required. Provisions for 1/4" glazing shall be accommodated by use of an adapter.

### **INSTALLATION**

Glass and framing shall be installed straight, plumb, and level without twisting and securely anchored in place. All joints between framing and the building exterior shall be sealed to provide a watertight installation.

### **PROTECTION AND CLEANING**

The General Contractor shall provide adequate protection of the aluminum and glass surfaces from damage by grinding compound, lime, acids, cement or other contaminants. The General Contractor shall be responsible for final cleaning.

Scale

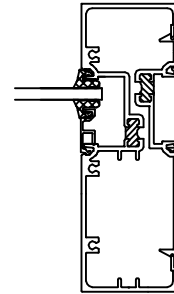
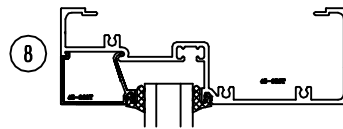
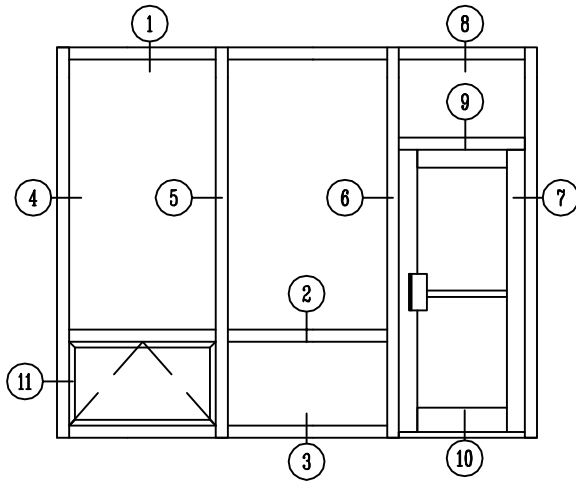

SINGLE GLAZE  
ADAPTOR

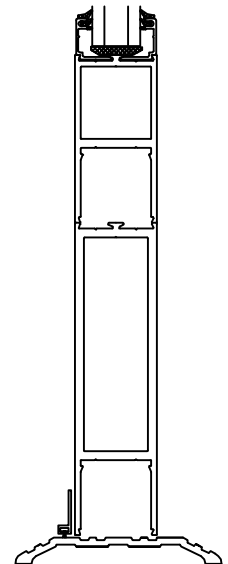
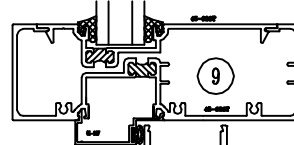

OPTIONAL 10" BOTTOM RAIL

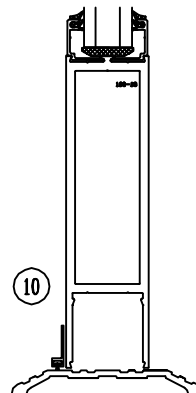
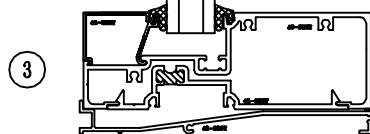
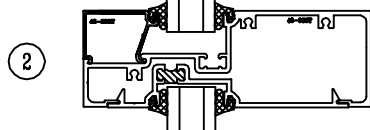
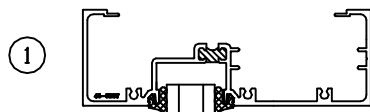

10

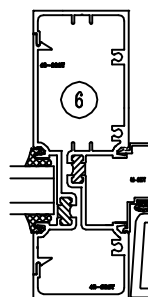
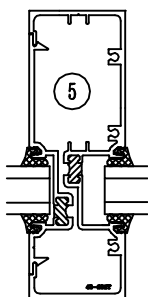
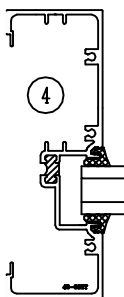

SINGLE ACTING DOOR

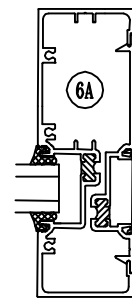
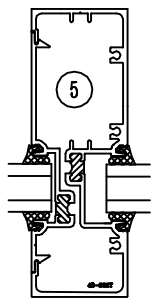
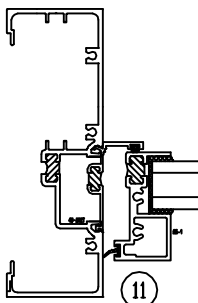
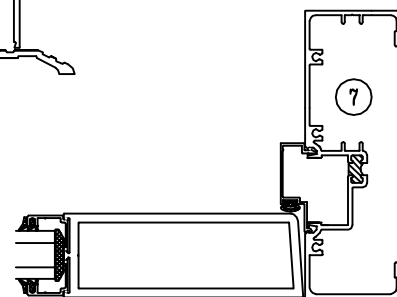

DOUBLE ACTING DOOR

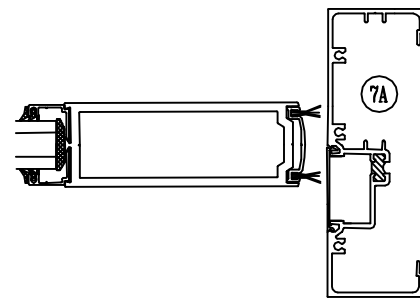

## WIND LOAD CHARTS

DEFLECTION LIMITED TO L/175

- A = 15 PSF
- B = 20 PSF
- C = 25 PSF
- D = 30 PSF

$I = 7.243$   
 $S = 1.977$

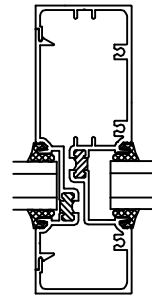
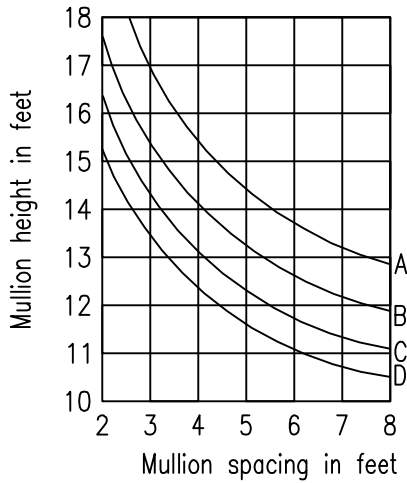

45-682T  
45-680T

w/ 1/4" STEEL (1.257)  
 $I = 8.498$

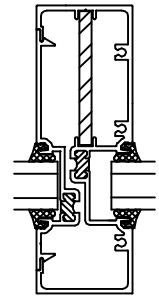
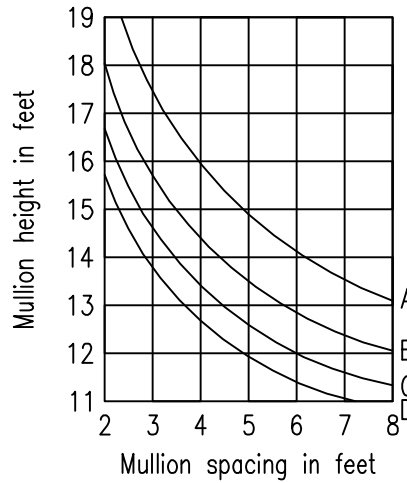

45-682T  
45-680T

## DEAD LOAD CHARTS

- 1/4 POINT LOADING (A)
- 1/8 POINT LOADING (B)

$I = .441$

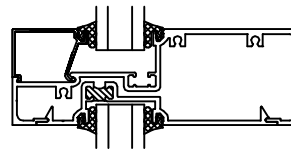
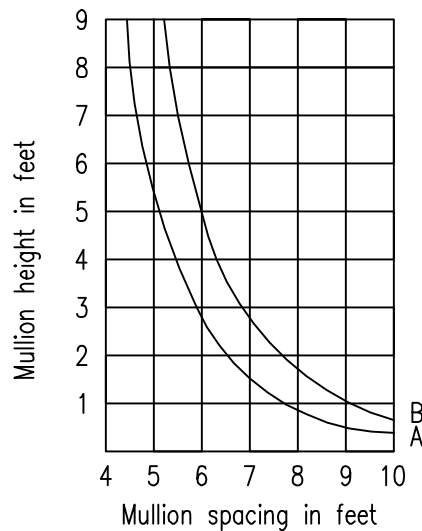

45-683T  
45-288T

① HEAD

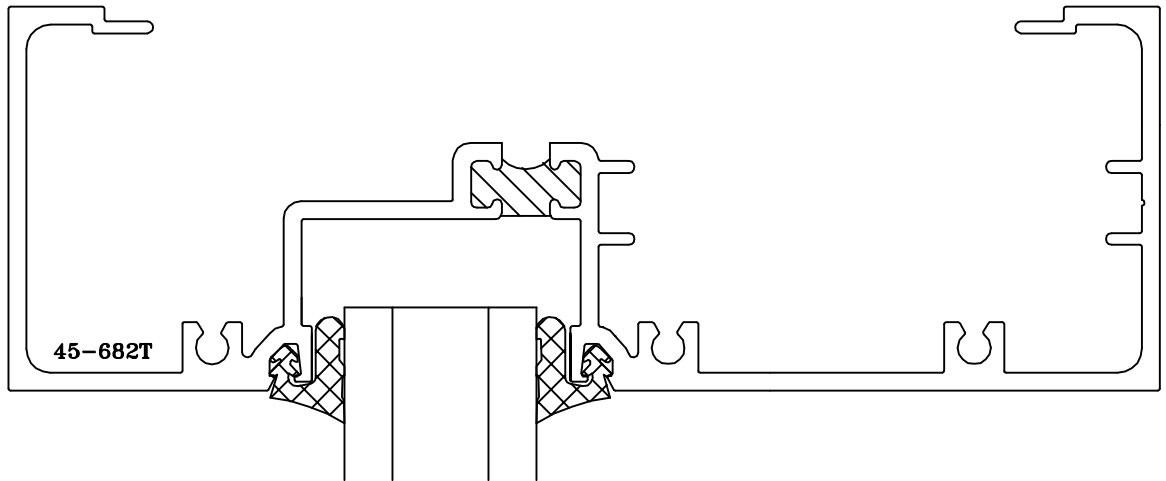

② HORIZONTAL

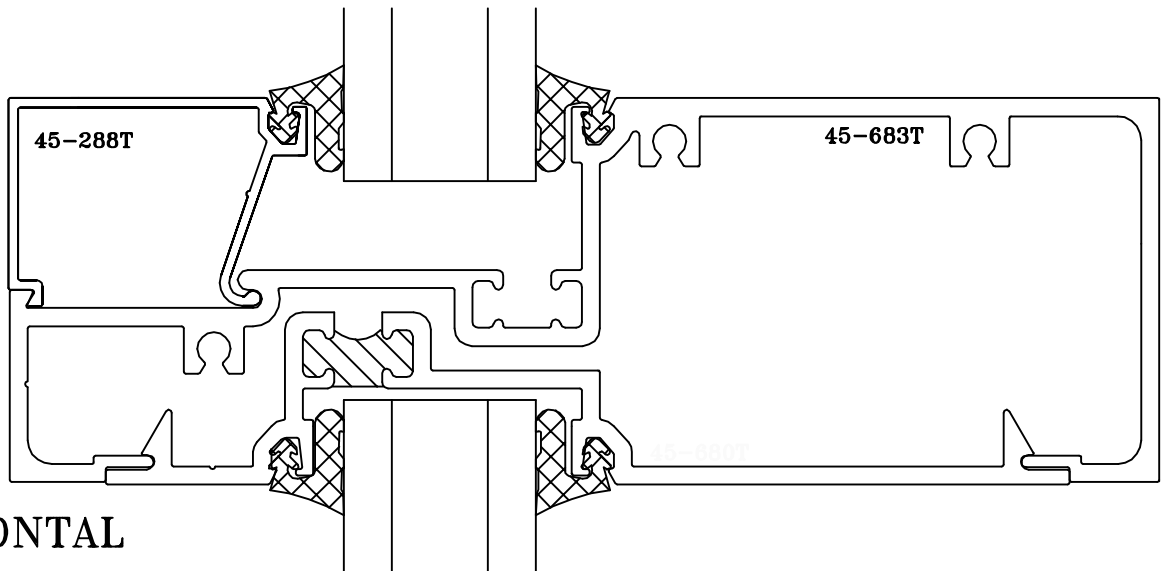

③ SILL

SUBSILL

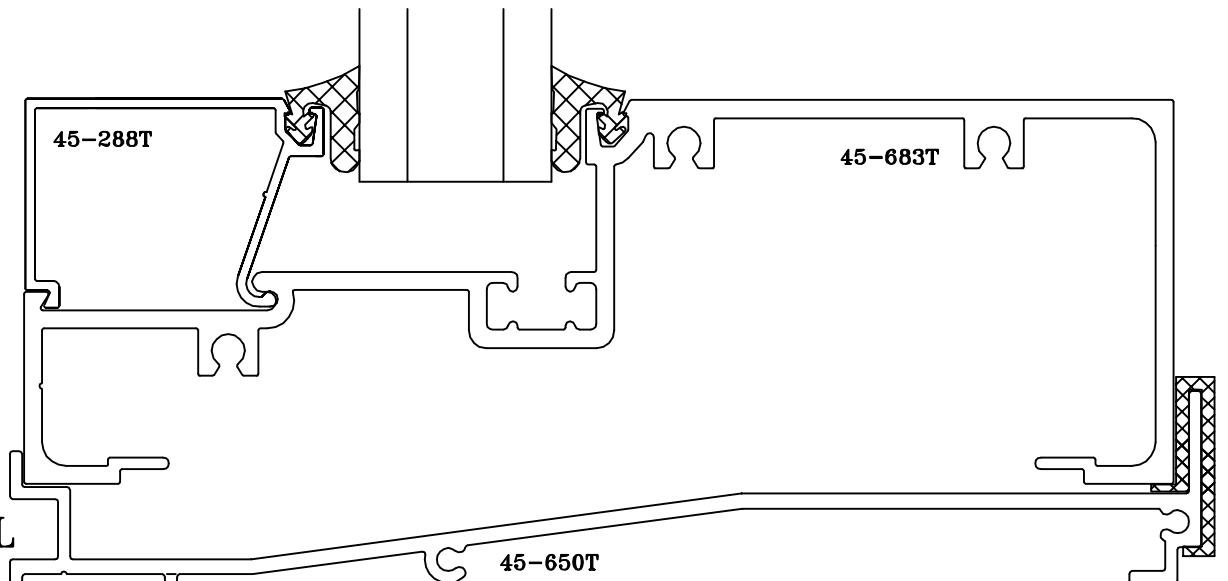

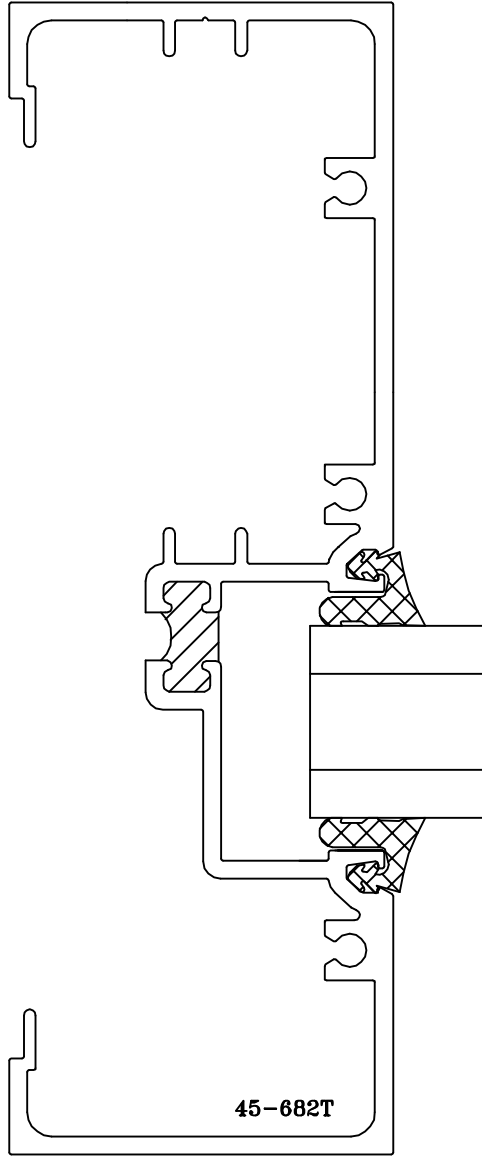

④ JAMB

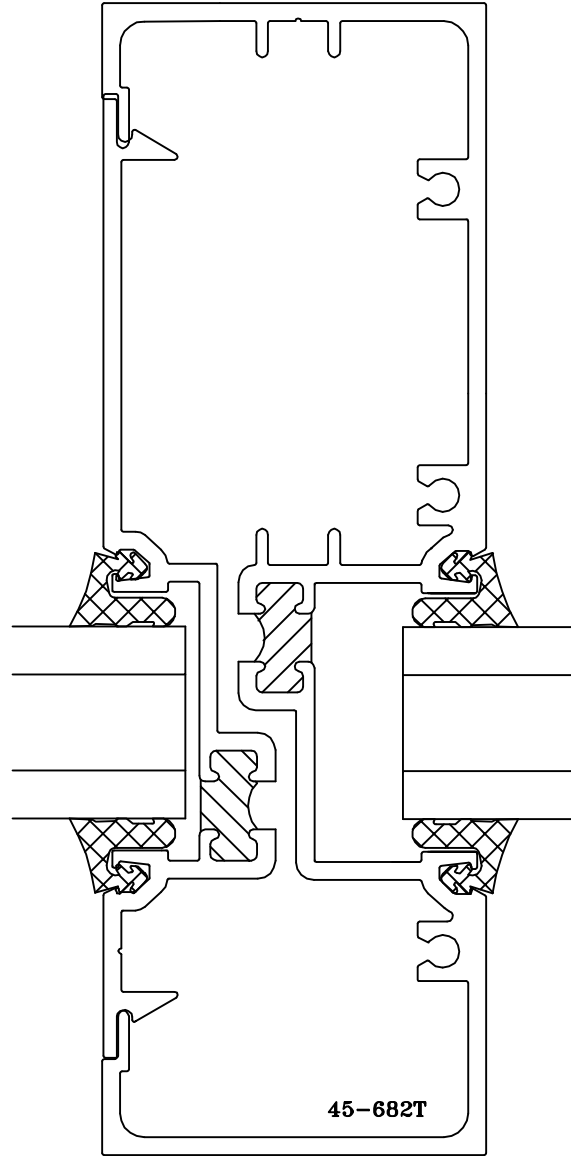

⑤ VERTICAL

SINGLE ACTING DOOR

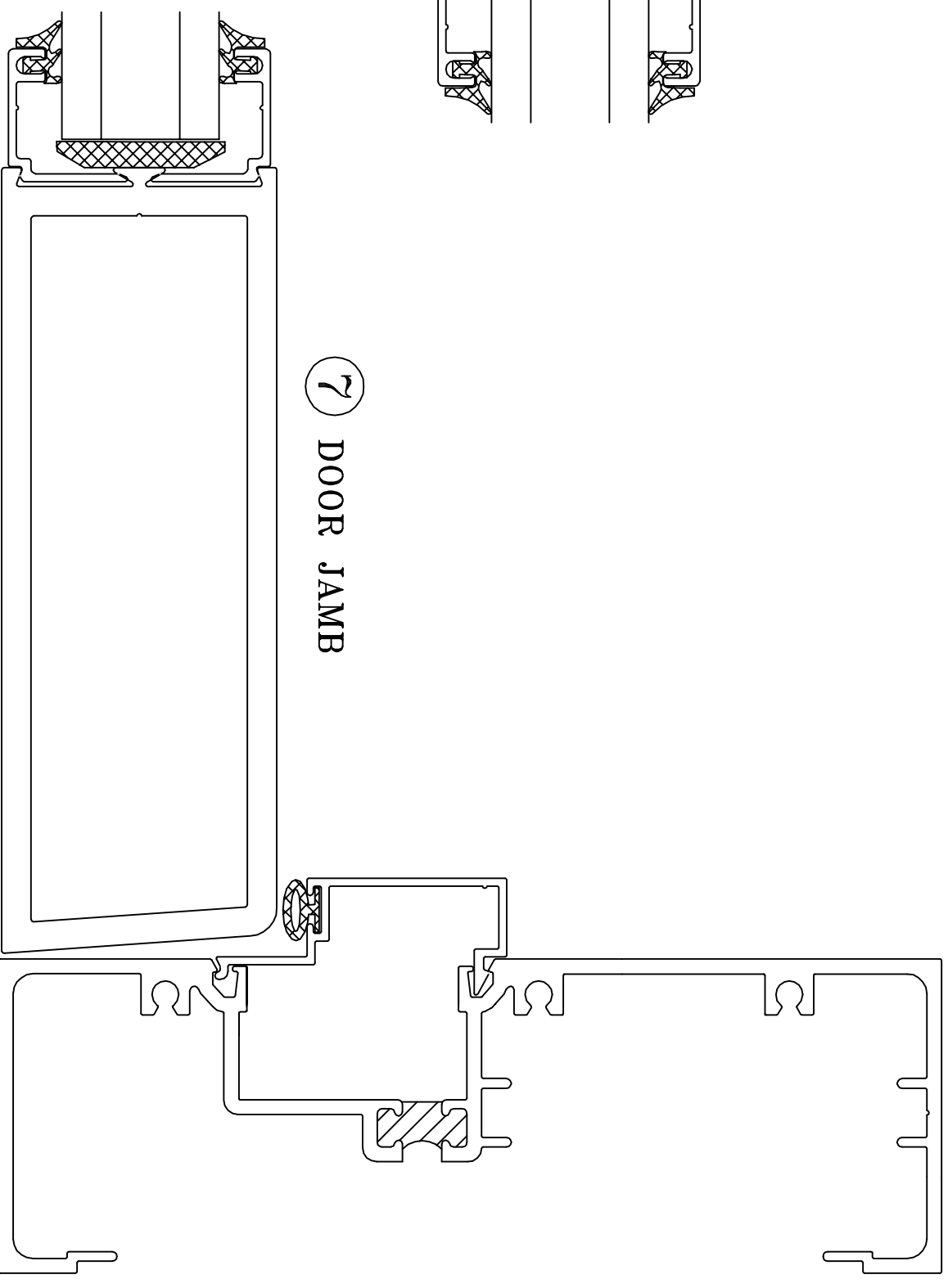
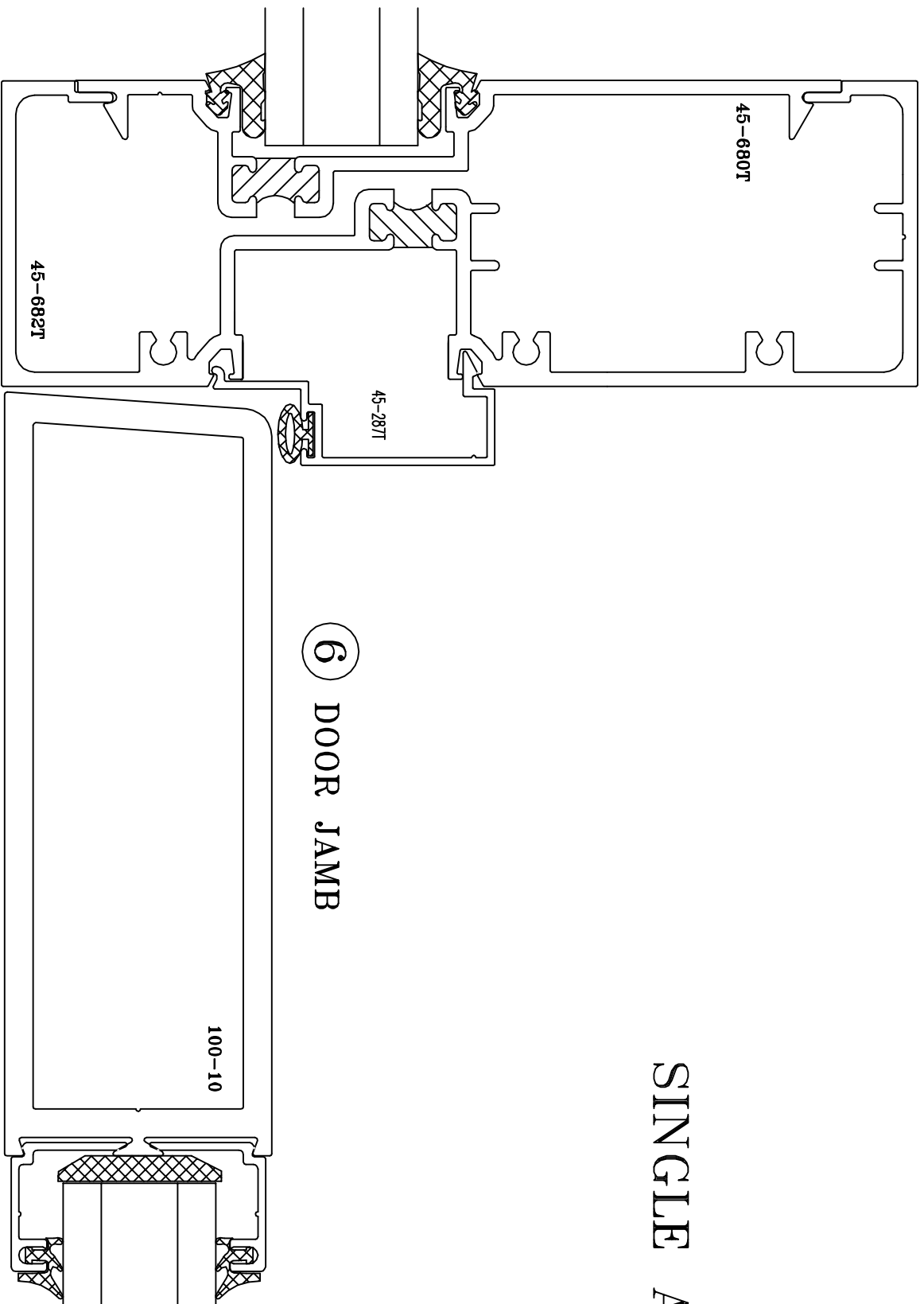

# DOUBLE ACTING DOOR

6A DOOR JAMB

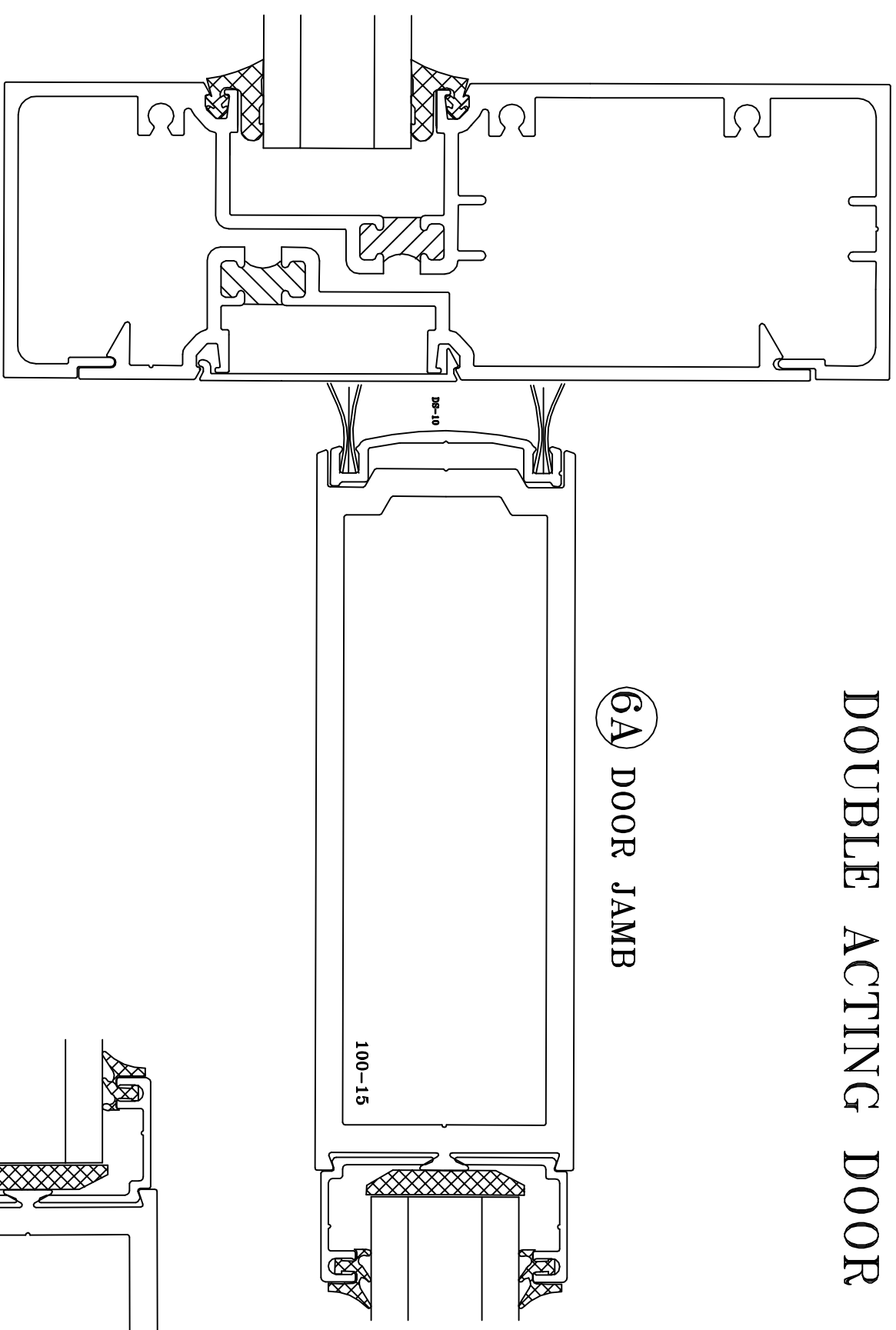

7A DOOR JAMB

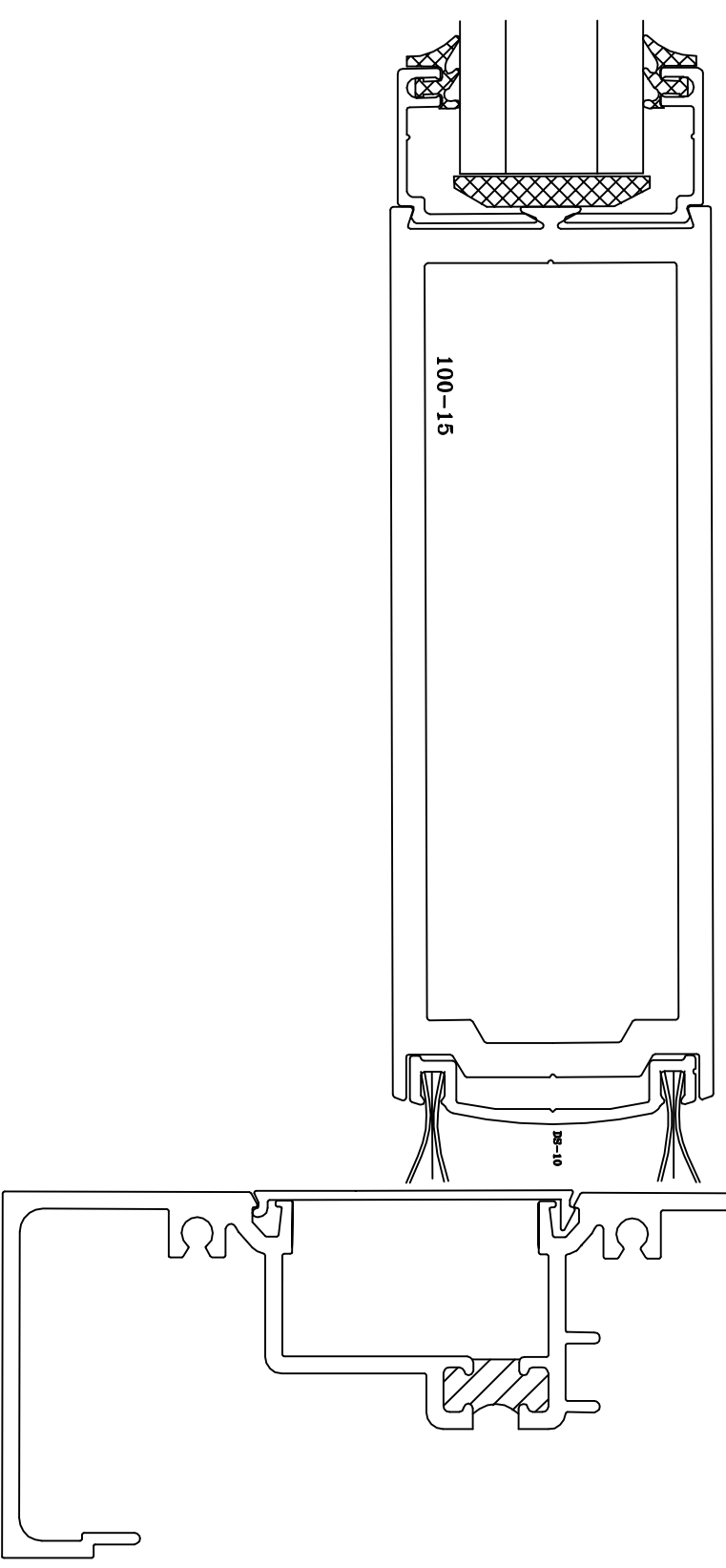

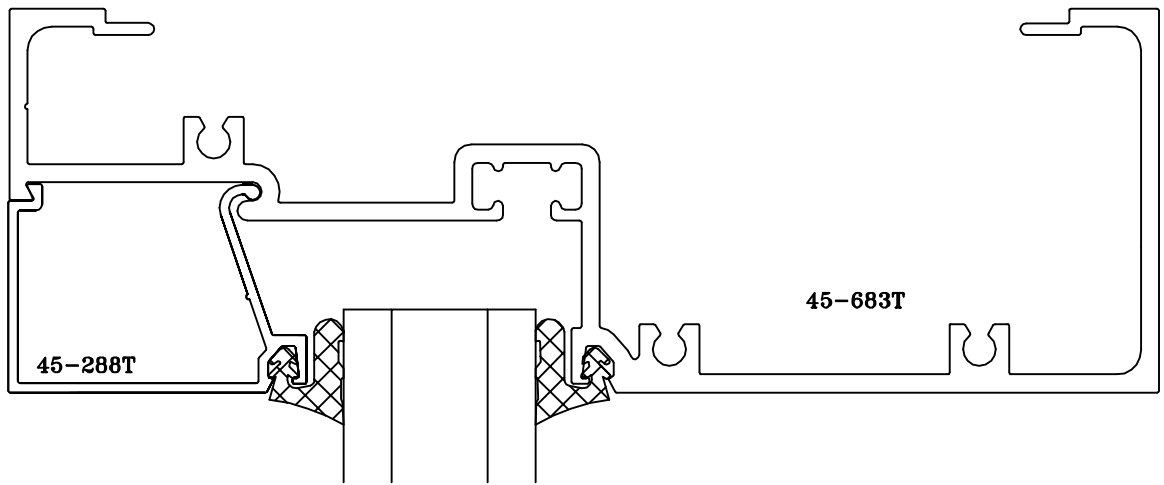

**8** HEAD



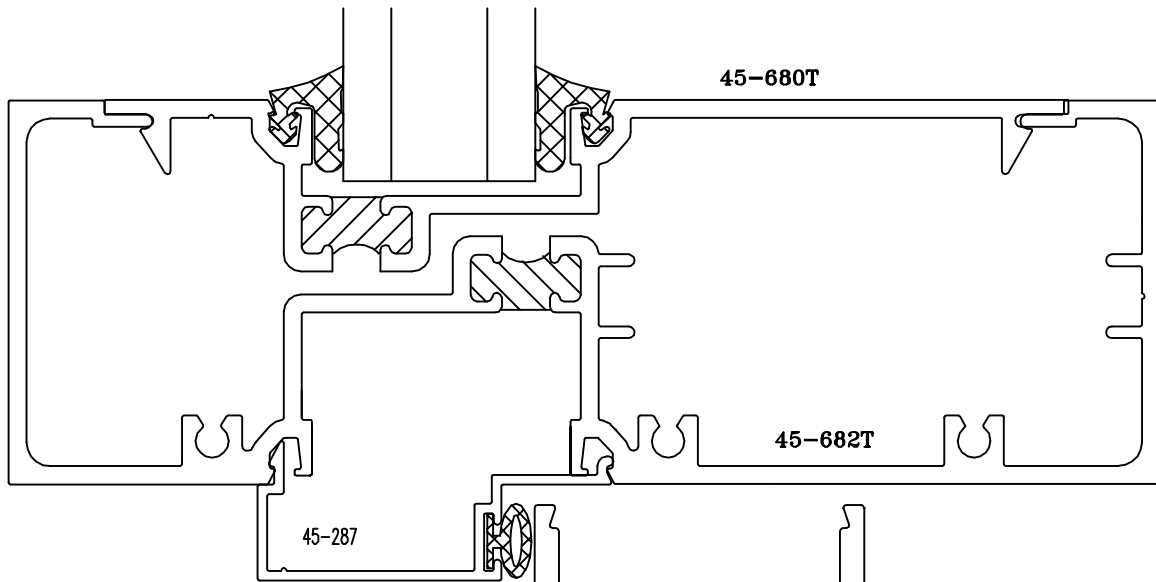

⑨ DOOR HEAD

SYSTEM 45T STOREFRONT  
2" x 6" THERMAL FRAMING

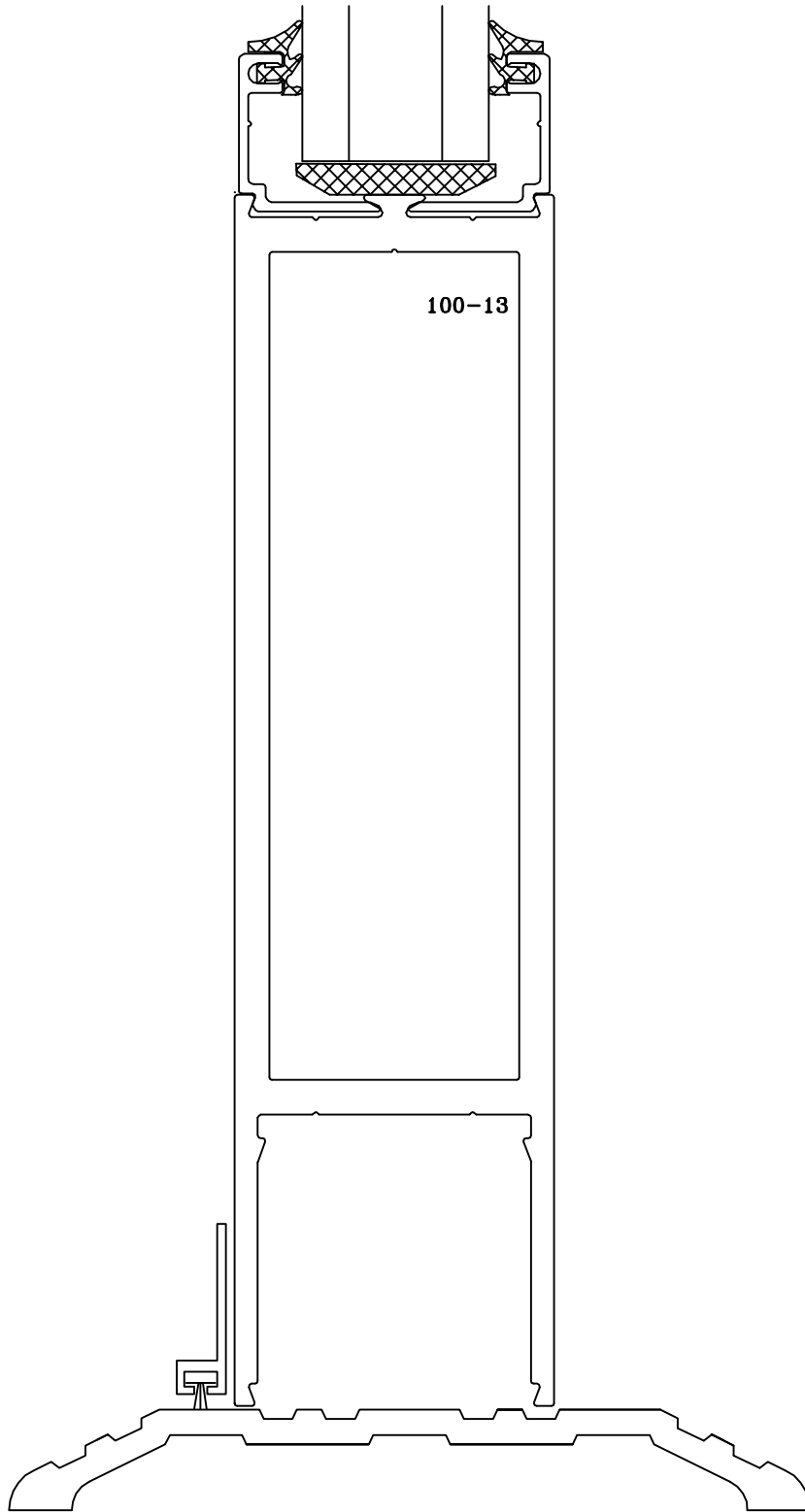

⑩ BOTTOM RAIL

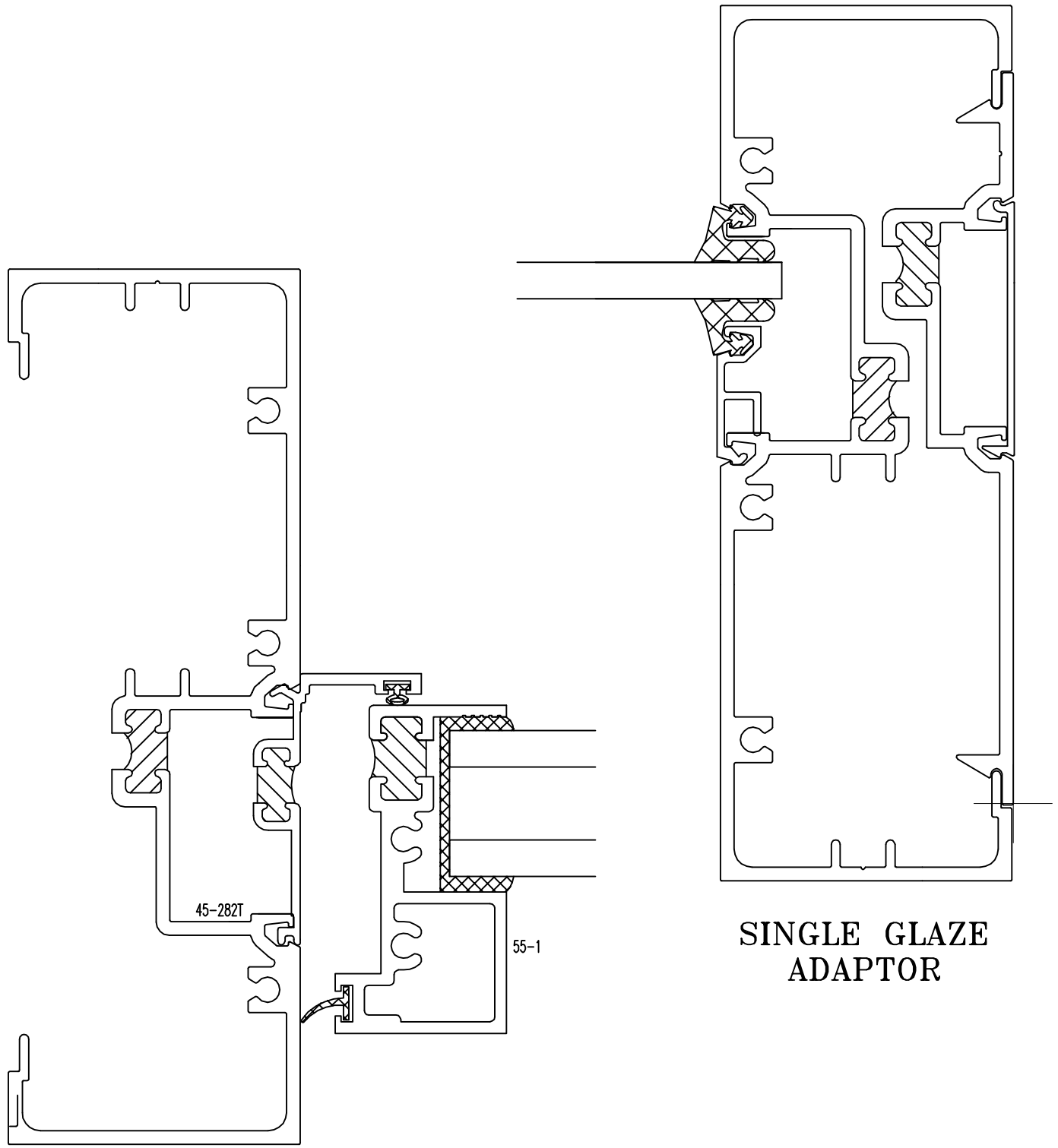

① JAMB

BUTT GLAZE CORNER

